

REELS - 1.000 SERIES

Construction: Drum with ribbed sheet metal sides for greater resistance. Shaft supported with bearings. Robust folded sheet metal support. Manual with brake, motorized with gears.

Material: Painted and oven-dried sheet steel or stainless steel.

Max. pressure: 210 bar, others on request.



E 1 2 06

M: Manual
E: Electric
H: Hydraulic
N: Pneumatic

Serie 2: 1/2"
3: 3/4"

Type:
06
12
18
24
28

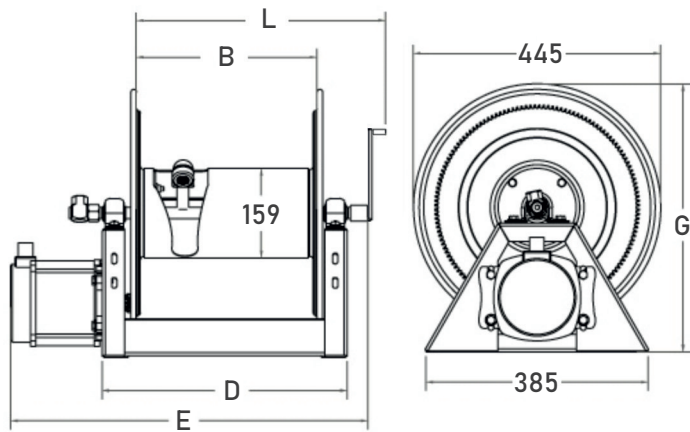

DIMENSIONS (mm)

Type	B	D	Manual L	Electric E	Hydraulic Pneumatic E	Manual G	Electric Hydraulic Pneumatic G	Weight Kg
06	152	289	552	467	419	460	476	16
12	305	441	705	619	570	460	476	18
18	457	594	857	770	728	460	476	22
24	610	746	1.010	924	876	460	476	24
28	711	848	1.110	1.025	978	460	476	26

GUIDES
Top or Bottom Mount

